

The Successful Dealer Award

Agenda

- 12:30 p.m.** Check in with Becky Burroughs at Show Info in Lobby F of the Kay Bailey Hutchison Convention Center
Becky will provide you with a badge that will allow you to access GATS and Market Movers, where the Successful Dealer Award will be presented.
- 12:45 p.m.** Meet at the Truckstop.com Theater on the Show Floor
Before or after Market Movers, we encourage you to explore the show floor at your leisure. The show will close at 5 p.m. on Thursday and re-open at 10 a.m. on Friday.

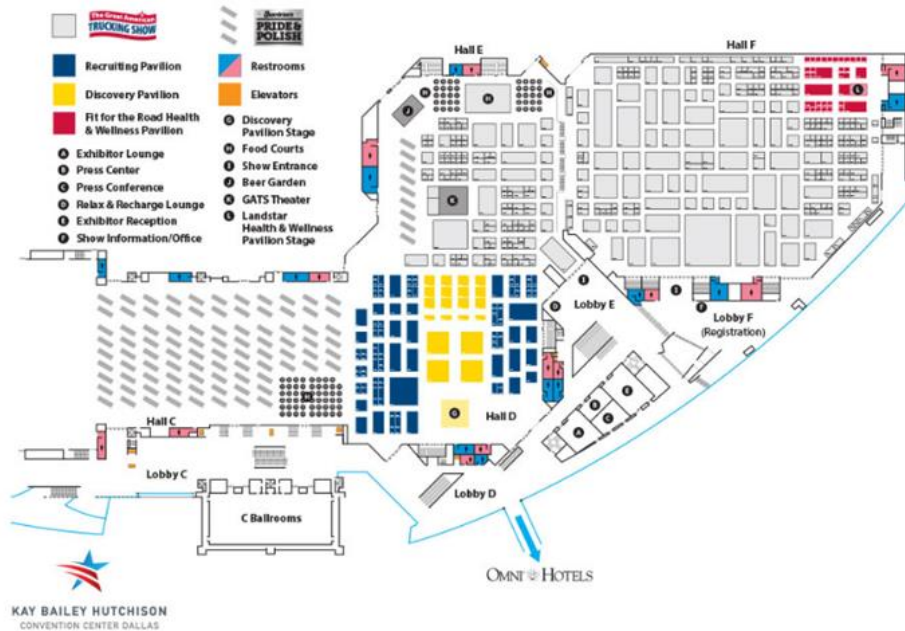

- 1:00 p.m.** Market Movers Event begins
Attire for the award ceremony is business/business casual with sport coat strongly recommended and tie optional.
- 2:30 p.m.** Deadline for Final Arrivals to the Truckstop.com Theater
- 3:00 p.m.** Announcement of Finalists and Award Presentation
- 6:00 p.m.** Celebration Dinner – Bob’s Steak & Chop House
*Bob’s Steak & Chop House is inside the Omni Dallas Hotel on the lobby level near the sports bar and the coffee shop.
A celebratory cocktail reception will begin at 6:00 PM, with dinner immediately to follow.
Attire for the reception/dinner is business casual with sport coat and tie optional.*

SPONSORED BY:



Accommodations

Omni Dallas Hotel
555 S Lamar
Dallas, Texas 75202
Phone: (800) 843-6664
Concierge: (214) 979-4505

You may check in to the hotel upon your arrival, but rooms are not guaranteed to be ready until 4:00 PM. You can check your luggage with the bellhop and request a text message when your room is ready. Although your room nights have been paid for in full, the Omni may request a credit card from you upon check-in to cover incidentals and any additional charges that you bill to your room during your stay.

Directions to the OMNI Dallas Hotel:

FROM DFW INTERNATIONAL AIRPORT – 19 MILES

Start going toward the airport exit on International Parkway South (toll applies). Make a U-turn on International Parkway North (TX-97-SPUR N) (toll applies) and go 0.6 miles. Take the ramp onto TX-114 East toward Irving/Downtown Dallas and go 10.8 miles. Merge onto TX-183 East and go 2.5 miles. Merge onto I-35E South and go 4.7 miles. Take Exit #428E/Commerce Street East/Reunion Boulevard onto Commerce Street and go 0.3 miles. Take the ramp onto Commerce Street and go 0.2 miles. Turn right on South Houston Street (TX-354-LOOP South) and go 0.2 miles. Turn left on Young Street and continue until Lamar Street intersection. Turn right on Lamar Street and entrance is on right before the next intersection.

DIRECTIONS FROM LOVE FIELD AIRPORT – 6.5 MILES

Starting at the center of zip code 75235 on Maple Avenue, go toward Hawes Avenue – about 0.2 miles. Turn right on West Mockingbird Lane and go 0.5 miles. Take the ramp onto Harry Hines Boulevard (TX-354-LOOP S) and go 0.7 miles. Take the ramp onto Inwood Road and go 0.6 miles. Turn left on North Stemmons Freeway and go 0.1 miles. Take the left ramp onto I-35E South and go 3.5 miles. Take Exit #428E/ Commerce Street East/Reunion Boulevard onto Commerce Street and go 0.3 miles. Take the ramp onto Commerce Street and go 0.2 miles. Turn right on South Houston Street (TX-354-LOOP S) and go 0.2 miles. Turn left on Young Street and continue until Lamar Street intersection. Turn right on Lamar Street and entrance is on right before the next intersection.

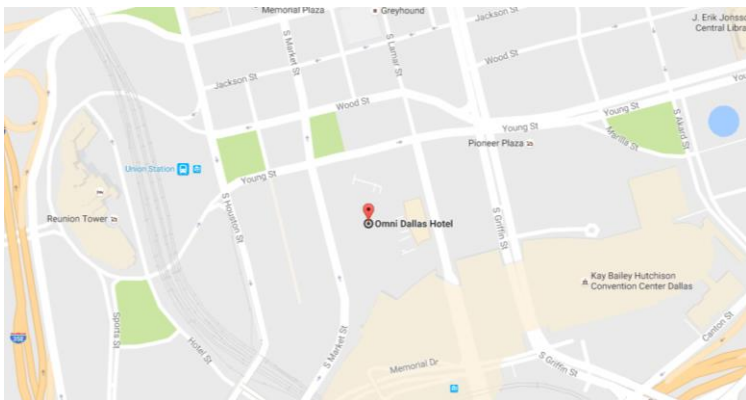

Parking at the OMNI Dallas Hotel:

Valet Parking Rates:

0 – 4 hours: \$19

4 – 8 hours: \$24

Overnight: \$30 – In and out privileges

2 hours: \$5 when validated at an Omni Dallas Hotel restaurant

Self-Parking Rates:

0 – 4 hours: \$12

4 – 8 hours: \$15

Overnight: \$20

2 hours: \$5 when validated at an Omni Dallas Hotel restaurant

SPONSORED BY:



Onsite Directions: OMNI Dallas Hotel

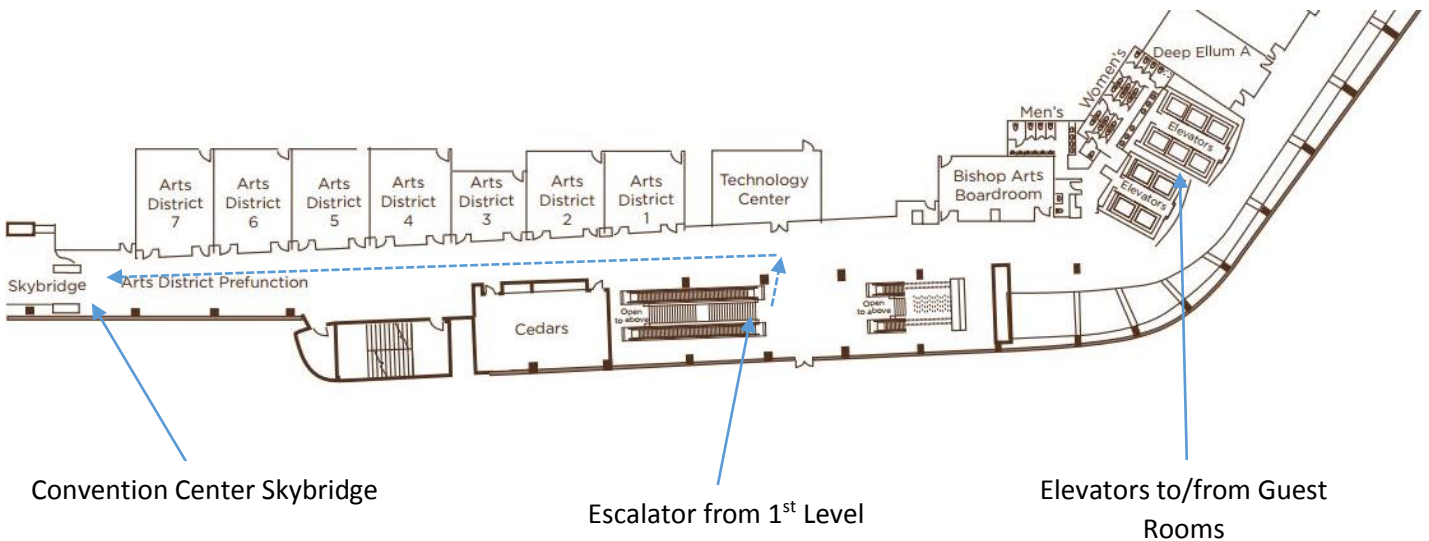
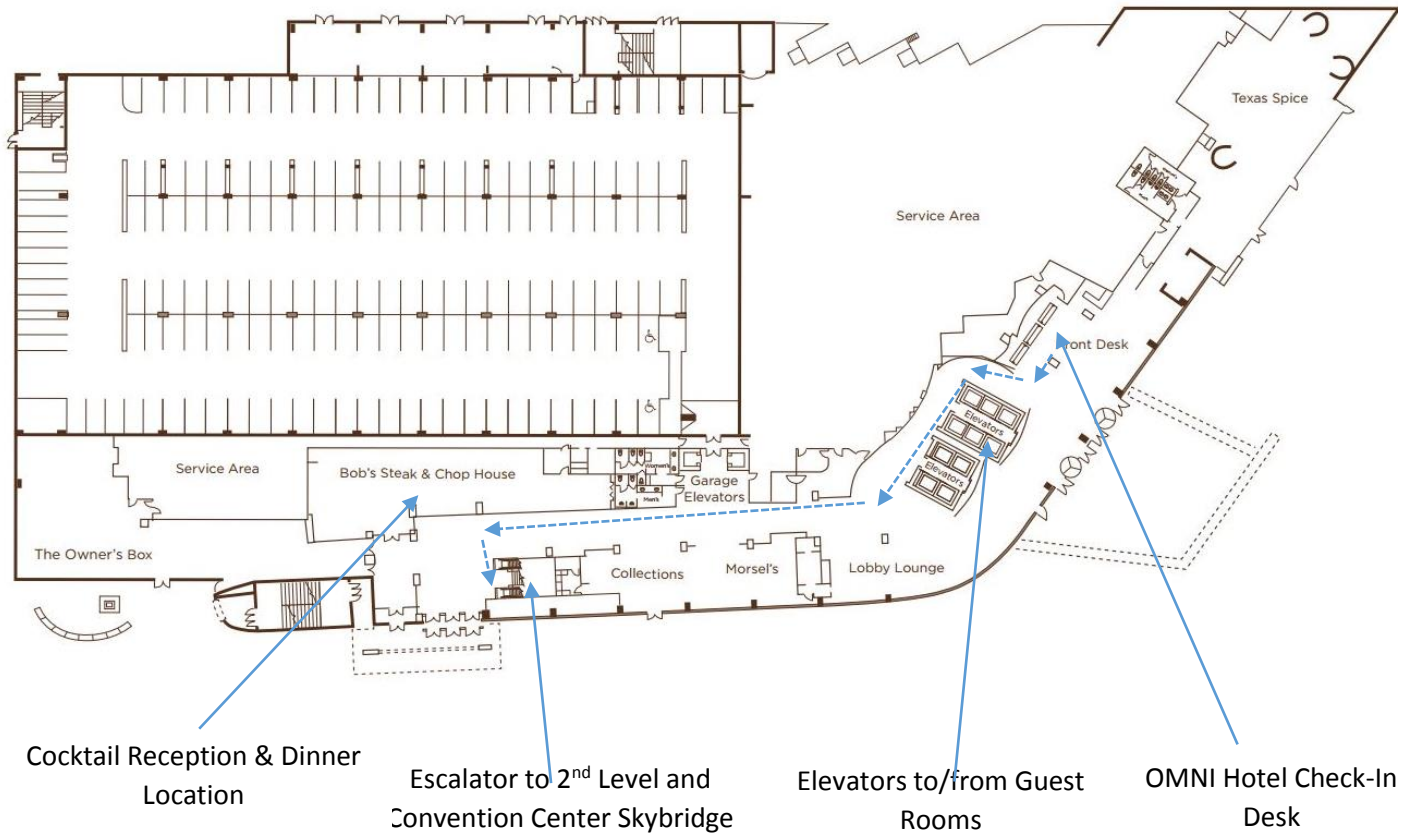

SPONSORED BY:



Onsite Directions: Convention Center

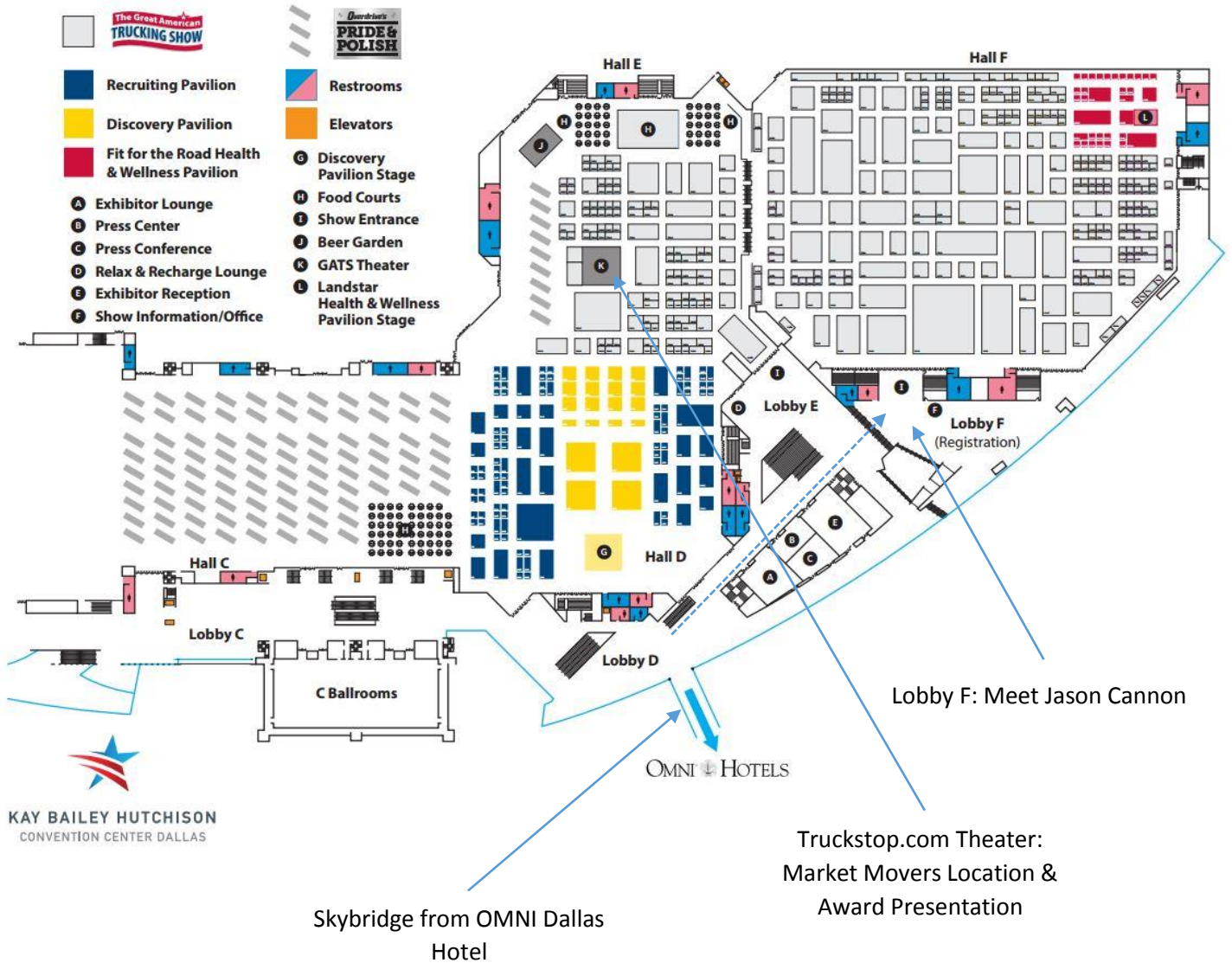

Onsite Contacts

Becky Burroughs	Director of Recognition & Specialty Events	404-861-5370
Jason Cannon	Equipment Editor, <i>Commercial Carrier Journal</i>	334-654-3111
Morgan Gamble	Audience Experience Manager, Events	205-310-1281

SPONSORED BY:

